

255 Welter Drive  
Monticello, IA 52310



P: 877.465.4344  
F: 877.465.4042  
www.oakstreetmfg.com

## SHEPARD BOOTH



Wood Seat Wood Back  
(-WSWB)

*Clear Coat finish*



Vinyl/Upholstered Seat Wood Back  
(-VSWB)

*Timber stain -  
Gray vinyl*



Wood Seat Vinyl Back  
(-WSUB)

*Autumn Haze stain -  
Hunter Green vinyl*



Vinyl/Upholstered Seat & Back  
(-VSUB)

*American walnut stain -  
Wine vinyl*

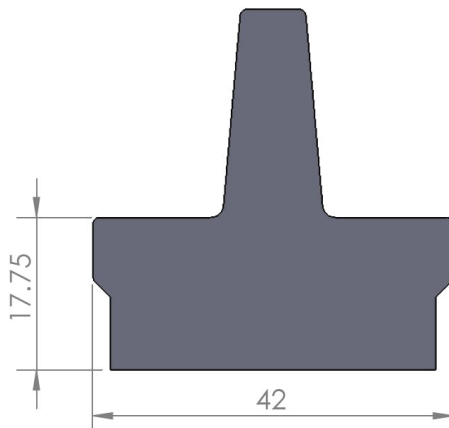
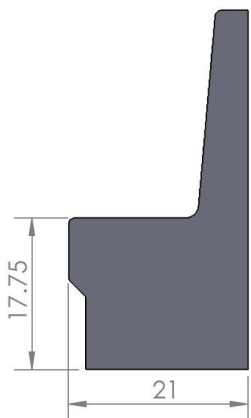

*Shepard Booth is available in the following options:*

- Single Booth - Wood Seat & Back (SHEP-SGL-WSWB)
- Single Booth - Vinyl or Upholstered Seat / Wood Back (SHEP-SGL-VSWB)
- Single Booth - Wood Seat / Vinyl or Upholstered Back (SHEP-SGL-WSUB)
- Single Booth - Vinyl or Upholstered Seat & Back (SHEP-SGL-VSUB)
- Double Booth - Wood Seat & Back (SHEP-DBL-WSWB)
- Double Booth - Vinyl or Upholstered Seat / Wood Back (SHEP-DBL-VSWB)
- Double Booth - Wood Seat / Vinyl or Upholstered Back (SHEP-DBL-WSUB)
- Double Booth - Vinyl or Upholstered Seat & Back (SHEP-DBL-VSUB)

- Heavy duty engineered wood end panels in oak stainable in your choice of standard in-house stain options: Clear Coat, Mahogany, Cherry, American Walnut, Dark Walnut, Black Stain/Dye, Autumn Haze, Timber, Rich Earth, Boardwalk, Dove Gray, Storm Gray & Fiesta series colors
- Both booth ends finished for endless room reconfiguration possibilities
- 30", 48", 60" & 72" standard lengths
- 36", 42" & 48" standard heights
- Standard unfinished outside back panel - optional oak veneer finished back available for an upcharge
- Vinyl/upholstery options for 1.75" thick, 18" deep seat and/or back include:
  - Black
  - Navy
  - Wine
  - Chestnut
  - Espresso
  - Hunter Green
  - Gray
  - Custom vinyl / upholstery - please visit our website at <http://bit.ly/vinyl-upholstery-fabric>
  - Red